

ORDINANCE NO. **10349**

1  
2 AN ORDINANCE relating to the annexation of  
3 an area known as 331-S to Soos Creek Water  
4 and Sewer District for the provision of  
5 sewer service.

6 STATEMENT OF FACT:

7 1. A notice of intention proposing the annexation of an  
8 area known as 331-S to Soos Creek Water and Sewer District was  
9 filed with the county council effective January 16, 1992.

10 2. Soos Creek Water and Sewer District has found the  
11 petition for annexation to be sufficient and has, by Resolution  
12 No. 0-724-S concurred with the proposed annexation.

13 3. Soos Creek Water and Sewer District filed a Declaration  
14 of Non-significant Impact dated October 24, 1991, on the  
15 proposed annexation.

16 4. The county council held a public hearing on the 2nd  
17 day of March, 1992 and has considered the  
18 criteria set forth in R.C.W. 56.02.060.

19 BE IT ORDAINED BY THE COUNCIL OF KING COUNTY:

20 SECTION 1. The annexation by Soos Creek Water and Sewer  
21 District of the area known as 331-S and described in Section 4  
22 herein is approved. This proposed annexation is consistent  
23 with R.C.W. 56.02.060 as described in the attached King County  
24 Council Annexation Report on 331-S.

25 SECTION 2. Soos Creek Water and Sewer District is the  
26 appropriate entity to serve the area proposed to be annexed for  
27 sewer service.

28 SECTION 3. Completion of this annexation does not  
29 constitute county approval or disapproval of any other permits,  
30 certifications, or actions necessary to provide service to this  
31 annexation area for water.

1      SECTION 4. The area known as 331-S to be annexed for sewer  
2 service is described as follows:

3      Beginning at the Northwest corner of the East 330 feet of  
4 the Northeast quarter of the Northeast quarter of Section 27,  
5 Township 22 North, Range 5 East, W.M., in King County,  
6 Washington, also being a point on the existing district  
7 boundary;

8      Thence Westerly along the North line of said Northeast  
9 quarter of the Northeast quarter to the East Line of the West  
10 half of the West half of said Northeast quarter of the  
11 Northeast quarter;

12      Thence Southerly along said East line to the North line of  
13 the South 660 feet of said Northeast quarter of the Northeast  
14 quarter;

15      Thence Easterly along said North line to the West line of  
16 the East 330 feet of the Northeast quarter of the Northeast  
17 quarter of said Section 27, also being a point on the existing  
18 District boundary;

19      Thence Northerly along said West line to the point of  
20 beginning.

21      INTRODUCED AND READ for the first time this 18<sup>th</sup> day  
22 of February, 1992.

23      PASSED this 20<sup>th</sup> day of April, 1992.  
24      KING COUNTY COUNCIL  
25      KING COUNTY, WASHINGTON

26      Audrey Luger  
27      chair

28      ATTEST:

29      Gerald A. Potvin  
30      Clerk of the Council

31      APPROVED this 30<sup>th</sup> day of April, 1992

32      Kim Hill  
33      King County Executive

RECEIVED  
SOOS CREEK WATER AND SEWER DISTRICT  
JAN 22 PM 12:51

10349

COUNCIL  
KING COUNTY COUNCIL  
PROPOSED ANNEXATION 331-S

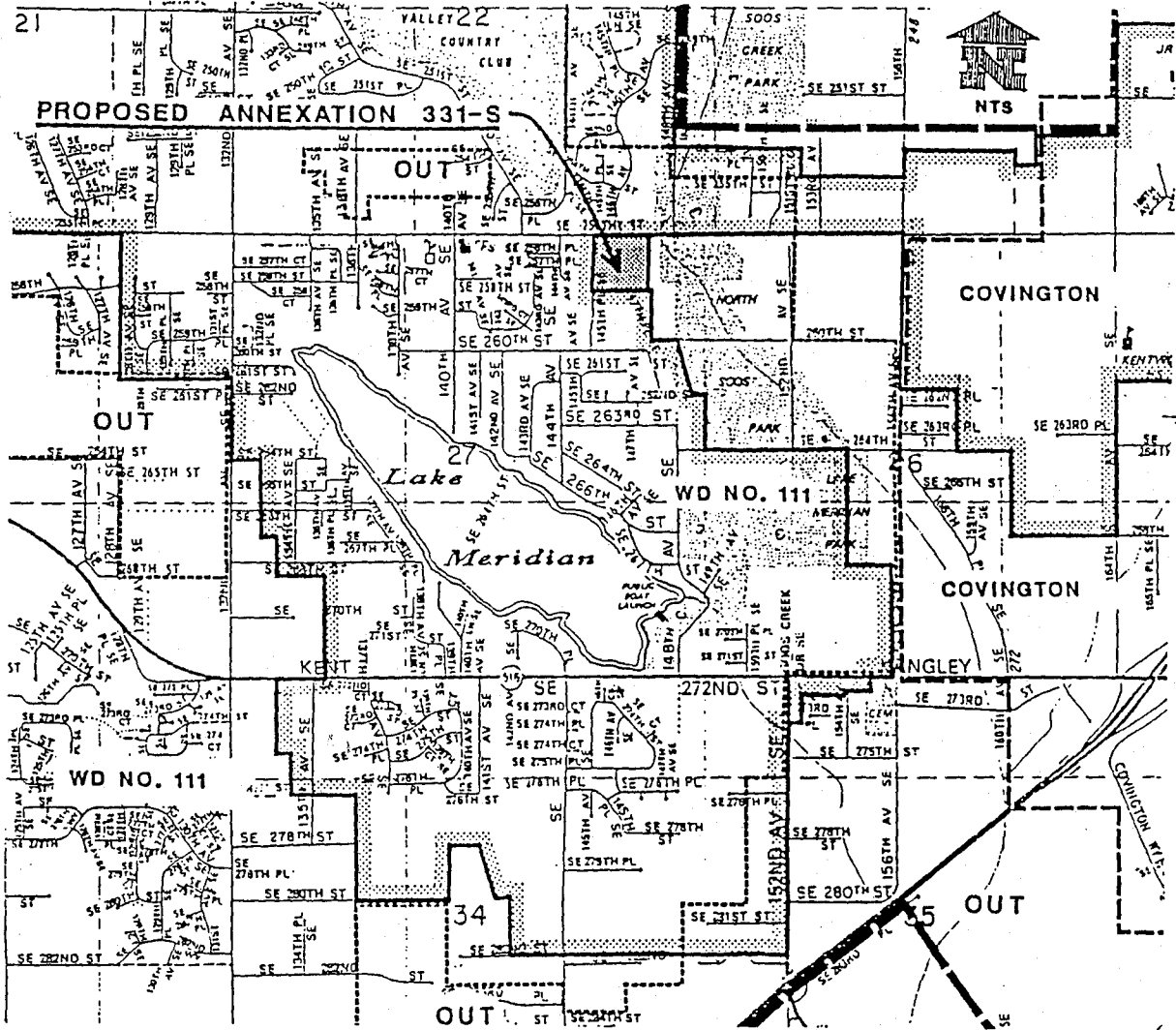

PROPOSED ANNEXATION 331-S  
(SEWER SERVICE AREA)

SOOS CREEK WATER AND SEWER DISTRICT  
(SEWER SERVICE AREA)

KING COUNTY LSA  
(SOOS CREEK COMMUNITY PLAN)

WATER DISTRICT NO. 111

COVINGTON WATER DISTRICT

ALL IN FIRE DISTRICT NO. 37

ALL IN SCHOOL DISTRICT NO. 415

ALL MAP WITHIN INCORPORATED KING COUNTY

EXHIBIT "I"